

**NOTES:**

- Opening schedule may change according to the structural design.
- The layout of columns and beams may change according to the structural design.
- Number of steps may change according to the plinth and parking height desired.
- Thickness of walls is only proposed. It may have to change based on the structural design to avoid column/beam projections.
- The Contractor and the Consultant shall bear no responsibility whatsoever where any drawings provided by it/them in relation to the project / Said Works, does not comply with any applicable laws including the bye-laws of the building/society where such project is situated. Further, it is clarified that it shall be the responsibility of the Owner to ensure any and all compliance of the drawings provided by the Contractor/Consultant.

**REV.**

**AREA STATEMENT**

Stilt floor area : 632 sft  
 Stilt floor common toilet : 38 sft  
 First floor area : 800 sft  
 First floor balcony : 120 sft  
 Second floor area : 800 sft  
 Second floor balcony : 41 sft  
 Staircase : 112 sft  
 Headroom : 122 sft

**DOOR SCHEDULE**

Main door MD : 3' 9" x 7' 0"  
 Flush door D1 : 3' 0" x 7' 0"  
 Toilet/Utility D2 : 2' 6" x 7' 0"

**WINDOW SCHEDULE**

Sliding window W1 : 7' 0" x 4' 6"  
 Sliding window W2 : 5' 0" x 4' 6"  
 Sliding window W3 : 3' 0" x 4' 6"  
 Kitchen window W4 : 3' 0" x 3' 6"  
 Ventilator V1 : 2' 0" x 2' 0"

**LEGENDS**

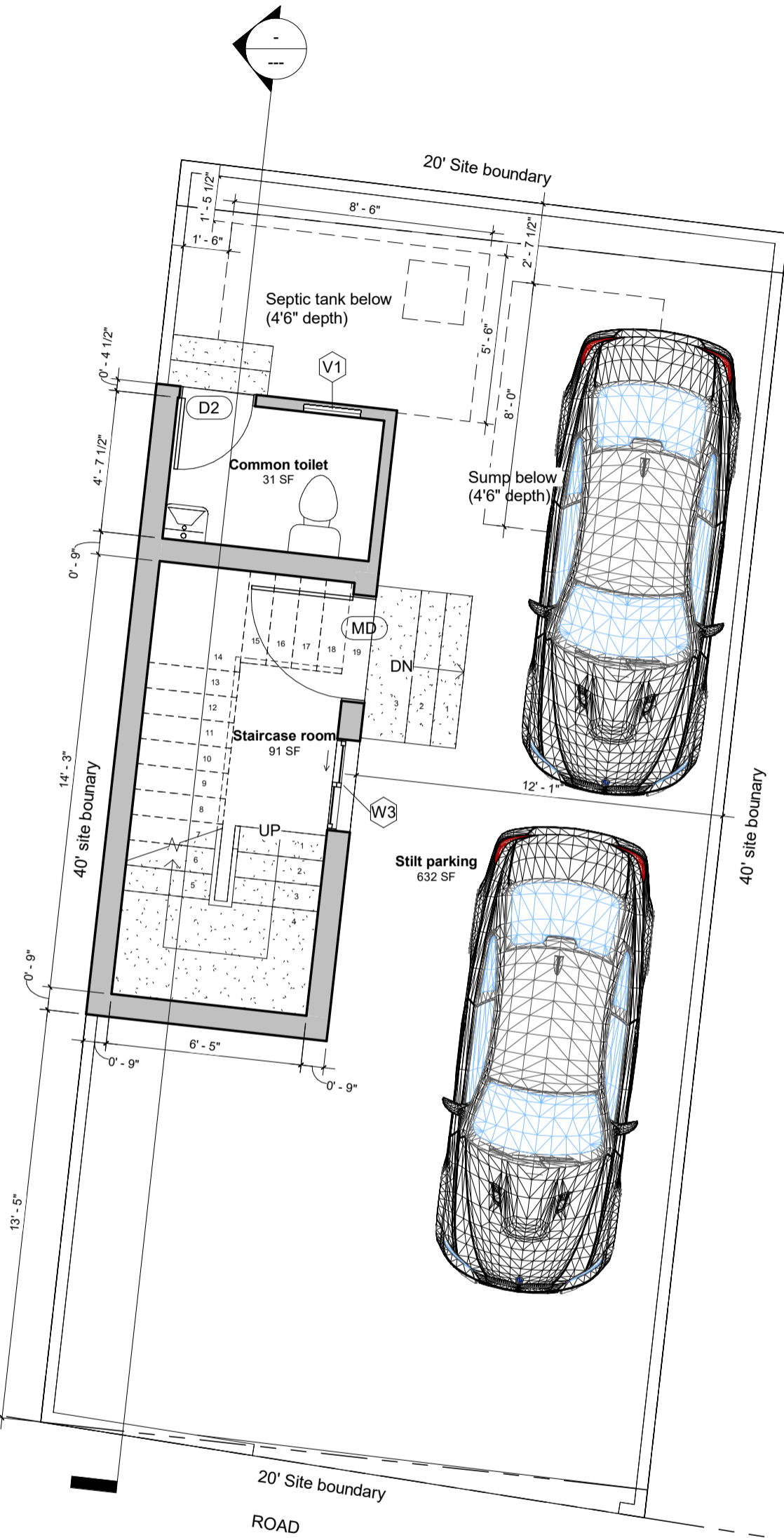

1 Ground Floor Level  
 1/4" = 1'-0"

**Brick & Bolt**

Equinox Managed Workspace,  
 Block II - Ground Floor, 6/13 North  
 Avenue, Kesavaperumalpuram,  
 R.A Puram, Chennai - 600028

Project  
**Mr. Balaji  
 Residence -  
 Iteration 1**

CRN  
 146696

Drg. No.  
 A101

Date  
 07/26/22

Drawing Title  
 Ground Floor Plan

Designed by  
 Asrar

