

General note.
 External wall 6" thick block masonry
 Internal wall 4" thick block masonry
 floor ht incl. slab 10'0"
 Toilet WC facing west.

ground floor.
 Built up area - 882.0 sft
 Deck - 59 sft

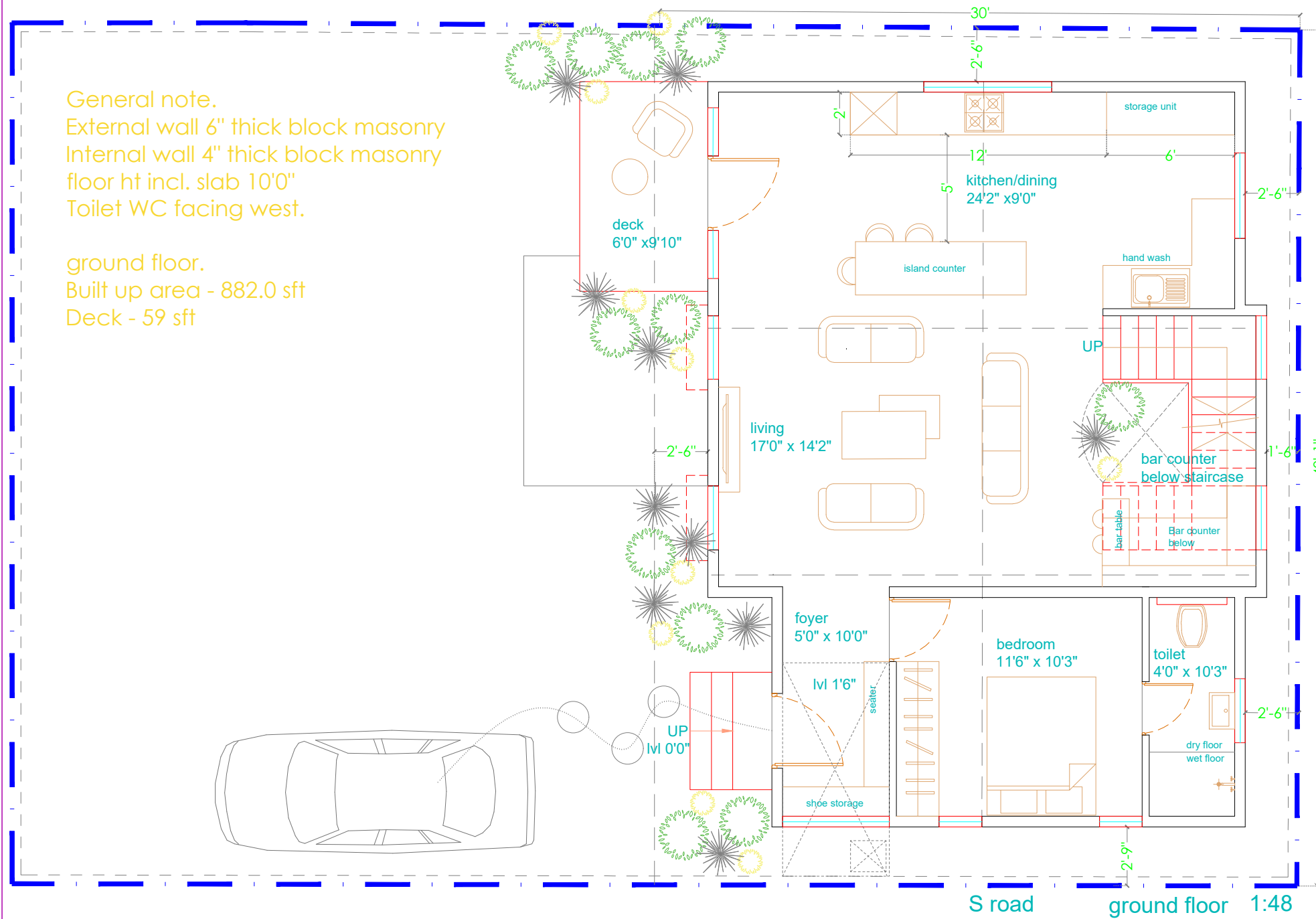

S road ground floor 1:48

NOTES:
 -All dimensions are in feet and inches.
 -Drawings to be read & not measured.

Details will supercede all drawings.

Clayworks, 16/2, 2nd Floor,
 Sobha Alexander Plaza,
 Commissariat Rd,
 Jashvik Nagar,
 Bengaluru, Karnataka 560025

Disclaimer: The Contractor and the Consultant shall bear no responsibility whatsoever when any change provided by others in relation to the project. Clayworks does not comply with any applicable laws including the fire-hood of the building/industry where each project is related. Further, it is clarified that it shall be the responsibility of the Owner to ensure any and all compliances of the drawings provided by the contractor/consultant.

-Opening schedule may change according to the structural design.
 -The layout of columns and beams may change according to the structural design.
 -Number of steps may change according to the plinth and parking height desired.
 -Thickness of walls is only proposed. It may have to change based on the structural design to avoid column/beam projections

Project	Project No. CRN - 153662	Sheet No. 1	Date 07-10-2022
Residence for Mr. Rahul Norona.	Drawing Title	R2	Scale nts
Designed by: Ar. Mujataba Khan	GROUND FLOOR PLAN		