

BUA- 980 SQFT
Balcony- 72 SQFT
Double height space- 889 SQFT

SECOND FLOOR PLAN

GOOD FOR CONSTRUCTION

GENERAL NOTES

1. CONSTRUCTION SPECIFICATIONS AS REPRESENTED BY SYMBOLS AND NOTATION SHALL BE THE PROPERTY OF THE ARCHITECT AND ARE SUBJECT TO THE DISCRETION OF THE ARCHITECT. THE ARCHITECT SHALL BE RESPONSIBLE FOR THE CORRECT INTERPRETATION AND THE ARCHITECT SHALL NOT BE RESPONSIBLE FOR THE CORRECT INTERPRETATION OF THE ARCHITECT'S INTENTIONS. THE ARCHITECT SHALL BE RESPONSIBLE FOR THE CORRECT INTERPRETATION OF THE ARCHITECT'S INTENTIONS. THE ARCHITECT SHALL BE RESPONSIBLE FOR THE CORRECT INTERPRETATION OF THE ARCHITECT'S INTENTIONS.

2. THE ARCHITECT SHALL NOT BE RESPONSIBLE FOR THE CONSTRUCTION DETAILS UNLESS THESE DETAILS, OR FROM THE ARCHITECT'S INTENTIONS, REQUIREMENTS OR SPECIFICATIONS. THE ARCHITECT'S CONTRACTOR SHALL BE RESPONSIBLE FOR THE PROVISION OF THE PROVISIONS AND DETAILS. THE ARCHITECT'S CONTRACTOR SHALL BE RESPONSIBLE FOR THE PROVISION OF THE PROVISIONS AND DETAILS. THE ARCHITECT'S CONTRACTOR SHALL BE RESPONSIBLE FOR THE PROVISION OF THE PROVISIONS AND DETAILS.

3. ALL WORK, MATERIALS AND EQUIPMENT SHALL MEET THE LATEST REQUIREMENTS OF ALL APPLICABLE CODES, REGULATIONS, AND SPECIFICATIONS OF THE ARCHITECT'S DESIGN, INTENTIONS, AND SPECIFICATIONS. THE ARCHITECT'S CONTRACTOR SHALL BE RESPONSIBLE FOR THE PROVISION OF THE PROVISIONS AND DETAILS. THE ARCHITECT'S CONTRACTOR SHALL BE RESPONSIBLE FOR THE PROVISION OF THE PROVISIONS AND DETAILS.

4. THE ARCHITECT SHALL NOT BE RESPONSIBLE FOR THE CONSTRUCTION DETAILS UNLESS THESE DETAILS, OR FROM THE ARCHITECT'S INTENTIONS, REQUIREMENTS OR SPECIFICATIONS. THE ARCHITECT'S CONTRACTOR SHALL BE RESPONSIBLE FOR THE PROVISION OF THE PROVISIONS AND DETAILS. THE ARCHITECT'S CONTRACTOR SHALL BE RESPONSIBLE FOR THE PROVISION OF THE PROVISIONS AND DETAILS.

5. THE ARCHITECT SHALL NOT BE RESPONSIBLE FOR THE CONSTRUCTION DETAILS UNLESS THESE DETAILS, OR FROM THE ARCHITECT'S INTENTIONS, REQUIREMENTS OR SPECIFICATIONS. THE ARCHITECT'S CONTRACTOR SHALL BE RESPONSIBLE FOR THE PROVISION OF THE PROVISIONS AND DETAILS. THE ARCHITECT'S CONTRACTOR SHALL BE RESPONSIBLE FOR THE PROVISION OF THE PROVISIONS AND DETAILS.

SPECIFIC NOTES

1. ALL LEVELS IN THIS DRAWING ARE UNFINISHED FLOOR LEVELS.

2. UNLESS SPECIFIED, ALL EXTERIOR WALLS ARE 200MM THICK.

3. ALL EXTERIOR WALLS ARE TO BE FINISHED WITH CHALKEN MASH FINISH.

4. ALL EXTERIOR WALLS ARE TO BE FINISHED WITH CHALKEN MASH FINISH.

5. ALL EXTERIOR WALLS ARE TO BE FINISHED WITH CHALKEN MASH FINISH.

6. ALL EXTERIOR WALLS ARE TO BE FINISHED WITH CHALKEN MASH FINISH.

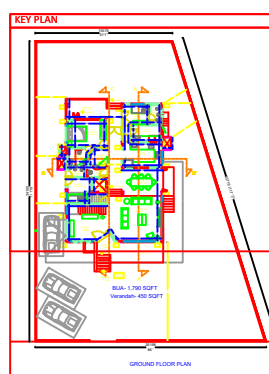

REV. NO.	DATE OF REV.	DESCRIPTION

NAME	DATE	NOS.	PURPOSE
Mr. Sunil Wakure	26.04.23	01	FOR CONSTRUCTION
Mr. Bala Nadar	26.04.23	01	FOR REFERENCE

REFERENCES	ABBREVIATIONS

PROJECT: Plot no. 31A
ROYAL PURANDAR,
605 / 1 DEWADI VILLAGE,
PUNE - 412205

CLIENT: Mrs. Vennila Nadar

DATE	25-04-2023	CHECKED	RKB
DRAWN	WK	APPROVED	RKB
PROJ. NO.	REDUPP372023	BLDG. ID.	35A

SCALE 1:80 @ A2 PAPER SIZE

STRUCTURAL CONSULTANT	BAM CHITALE & ASSOCIATES	DRG. NO.	A-205
PROJECT MANAGEMENT			R-00
CONTRACTOR	RP INFRA		

PREPARED BY:
R.D. DESIGN STUDIO
R.D. DESIGN STUDIO
R.D. DESIGN STUDIO
R.D. DESIGN STUDIO

TITLE: MEZZANINE FLOOR PLAN